

This document is subject to change without notice
This document is the exclusive property of DÉTI SAS and cannot be communicated to third parties or reproduced without prior written permission

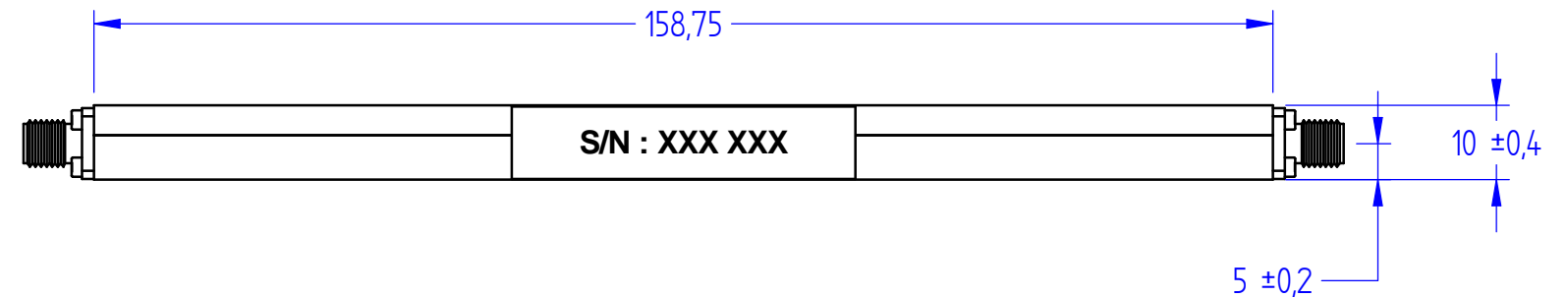
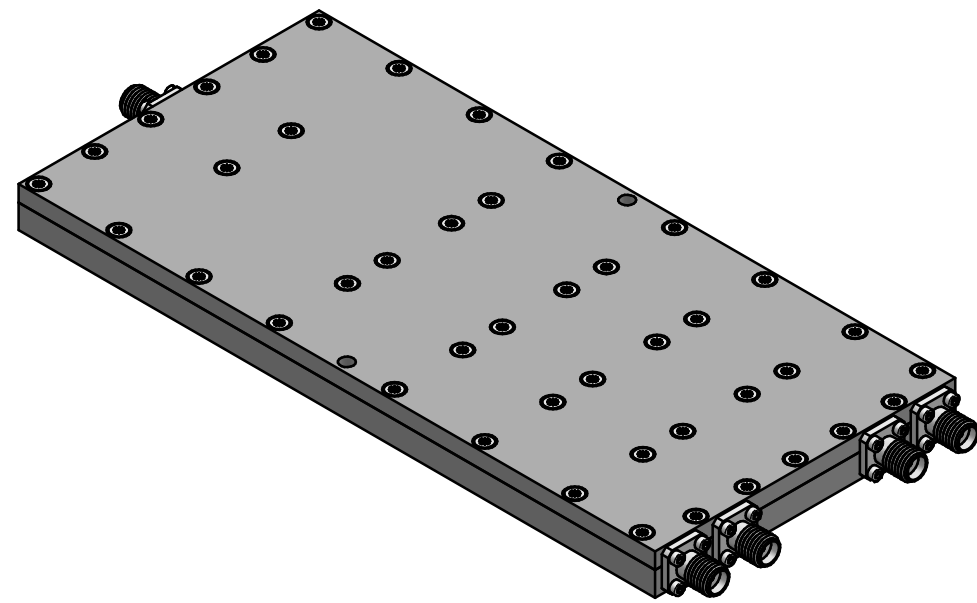

TECHNICAL SPECIFICATIONS

- Frequency Range :** 800 - 3000 MHz
- Insertion Loss :** 1.3 dB max.
- Amplitude Balance :** 0.5 dB max.
- Phase Balance :** 6° max.
- Input VSWR :** 1.6:1 max.
- Output VSWR :** 1.6:1 max.
- Isolation :** 20 dB min.
- Power Handling :** 30 W average @ 1.2:1 VSWR Load
- Operating Temperature :** -40°C to +85°C
- Storage Temperature :** -55°C to +125°C
- Mechanical Shocks :** MIL STD 202 - Method 213
Test cond. C: 100g 6ms ½
- Sinus Vibrations :** MIL STD 202 - Method 204D
Test cond. A : 10g / 10-2000HZ
- Thermal Shocks :** MIL STD 202 - Method 107G
Test cond. A: -40°C/+85°C
- Humidity :** MIL STD 202 - Method 103
Test cond. B : 95% 96h

SMA FEMALE CONNECTOR

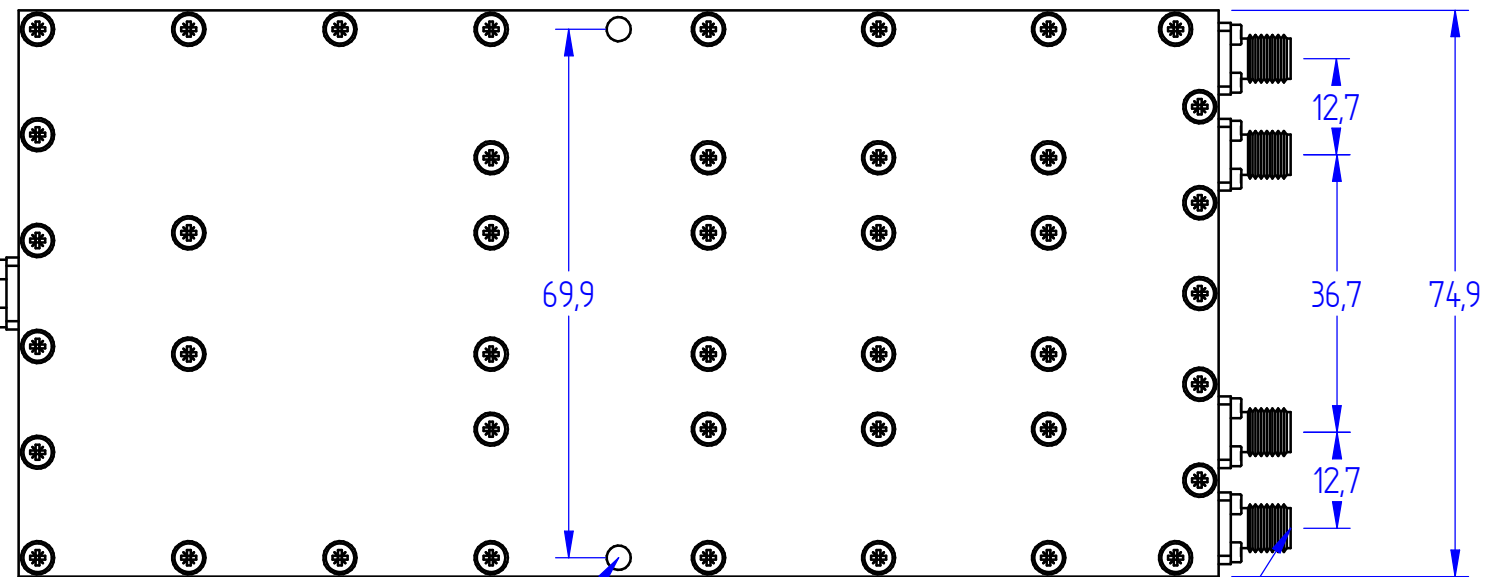

(x2) Ø 3,2 Débouchant

(x4) SMA FEMALE CONNECTOR

Last rev. additional information :							Material : Aluminium		Titre : Diviseur de Puissance 4 Voies	
							Treatment : Surtec 650		Titre : 4-Way Power Divider	
							Finish : Black Paint (mat)		Comment : DI-4-400-6000-30-SF-SF	
							Gen. Tol. : ISO 2768 - mK		Document Number : 800038 0A 1601 C	
							Orientation :		Drawn : aleguellec	
							Size : A3		Date : 15/06/2020	
							Scale : 1:1			
							Sheet : 1 / 1			
Rev.	Change	Drawn	Date	Check	Date	Approb.	Date			
C	Correction couleur produit	A. Le Gouellec	15/06/2020	W.Kherraz	15/06/2020	S. Mellaza	15/06/2020			
B	Modification du cartouche	A. Le Gouellec	15/06/2020	W.Kherraz	15/06/2020	S. Mellaza	15/06/2020			
A	Création du document	S. Mellaza	01/12/2017							



www.deti-sa.com